



PRODUCT DATA SHEET

QH11015

Our patented 3 dB 90° Hybrid Couplers provide:

- Superior component performance starting at 3:1 Bandwidth.
- Thicker center boards for high power and increased repeatability.
- Bonded structures which eliminate any air gaps between substrates.
- More sections per bandwidth for better coupling flatness.
- Electrically shorter and physically smaller RF components.

Features:

High Power Wide Bandwidths Small Size Connectorized Drop-In & Surface Mount

Electrical Specifications:

Frequency: 20-1000 MHz
 Power: 300 W CW
 Insertion Loss: 0.8 dB Max.
 VSWR: 1.45:1 Max.
 Phase Balance: $90^\circ \pm 10^\circ$ Max.
 Amplitude Balance: ± 0.25 dB Max.
 Isolation: 20 dB Min.

Mechanical Specifications:

Type: Connectorized
 Material: Aluminum 6061-T6
 Surface Finish: Chem. Film Per MIL-DTL-5541F Type I Class 3 (Yellow Iridite) RoHS Compliant Available
 Operating Temperature: -55°C to +75°C
 Storage Temperature: -60°C to +85°C
 Size: 4.10 x 3.10 x 1.25"

Connector Configurations:

Model	Sum Port (J1)	Inputs (J2,J3)	Ext. Load Port
QH11015-10	N Female	N Female	Not Applicable
QH11015-12	N Female	SMA	Not Applicable

Werlatone's breakthrough technology allows us to build our existing line of Broadband 3 dB High Power 90° Hybrid Couplers. Connectorized 3 dB 90° Hybrid Coupler models are available with a choice of connectors.

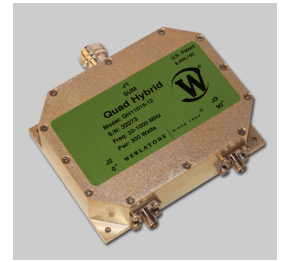

PRODUCT DATA SHEET

QH11015

Performance Data (Specifications subject to change without notice):

Graph 1: VSWR, Graph 2: Coupling, Graph 3: Phase Balance, Graph 4: Isolation

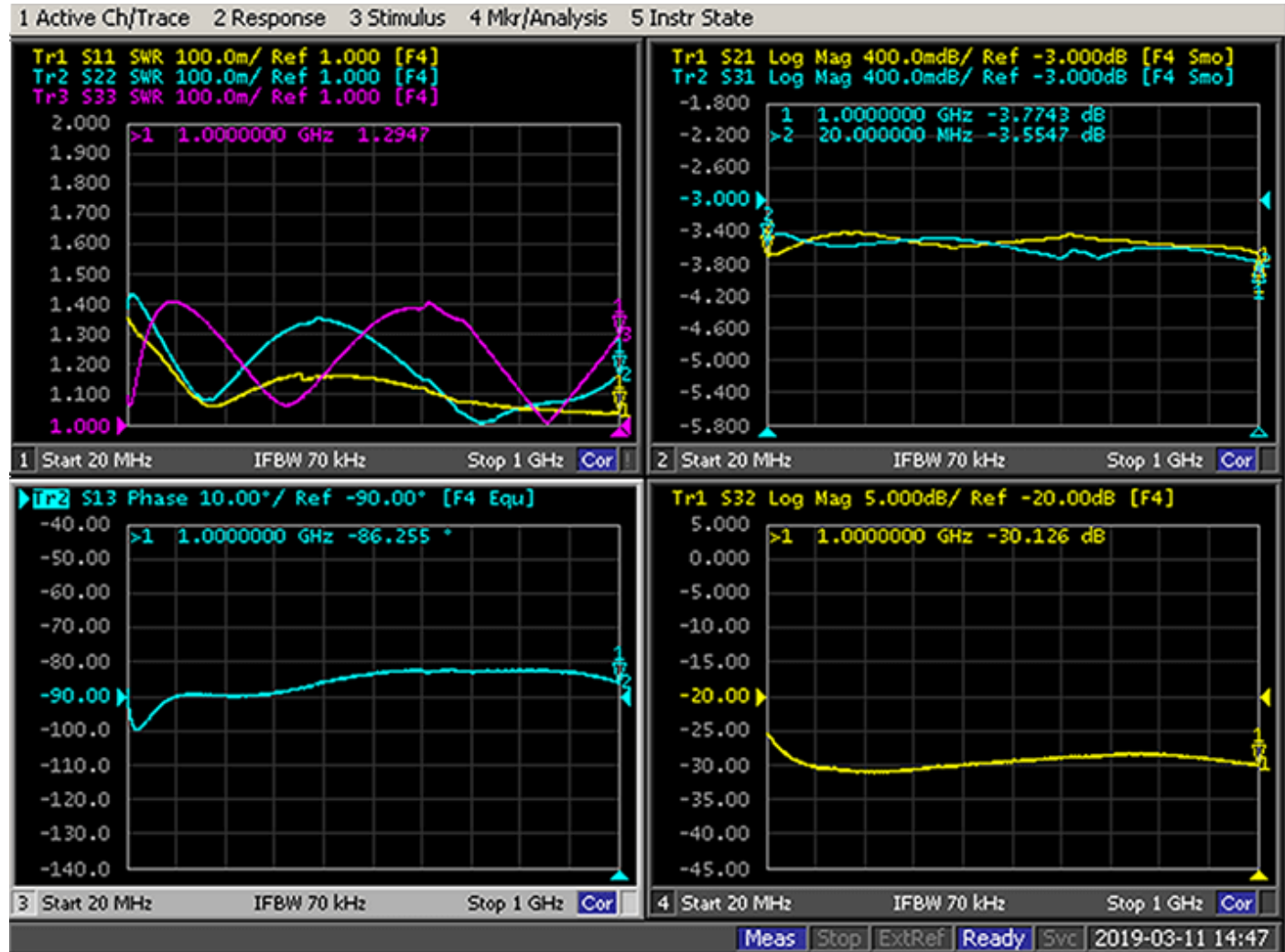

RESTRICTION ON USE, DUPLICATION OR
DISCLOSURE OF PROPRIETARY INFORMATION
This document contains proprietary information
which is the sole property of Werlatone, Inc.

REVISION HISTORY			
REV.	REVISION RECORD	DATE	APPROVED
-	INITIAL RELEASE	2/2/2017	PR

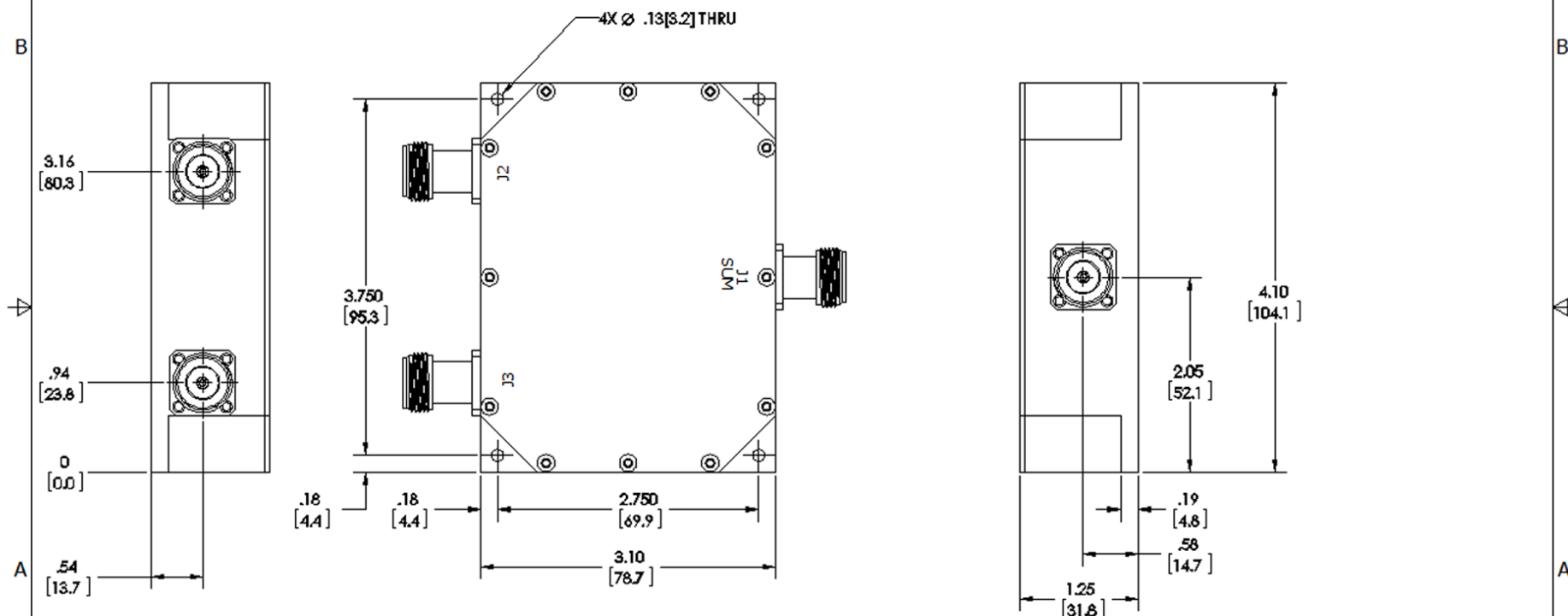

NOTES: UNLESS OTHERWISE NOTED

1. ALUMINUM 6061-T6
2. FINISH: CHEM FILM PER MIL-DTL-5541F TYPE I CLASS 3 (YELLOW IRIDITE)
3. CONNECTORS: N (FEMALE)

UNLESS OTHERWISE SPECIFIED		DATE	2/2/2017
DESIGN	DATE	2/2/2017	
CHK	DATE	2/2/2017	
APP	DATE	2/2/2017	
DESIGN	DATE	2/2/2017	
CHK	DATE	2/2/2017	
APP	DATE	2/2/2017	
DESIGN	DATE	2/2/2017	
CHK	DATE	2/2/2017	
APP	DATE	2/2/2017	
NEXT ASSY USED ON		DATE	2/2/2017
APPLICATION		DATE	2/2/2017
THIRD ANGLE PROJECTION		DATE	2/2/2017
TITLE		DATE	2/2/2017
OUTLINE		DATE	2/2/2017
SIZE		DATE	2/2/2017
B 28812		DATE	2/2/2017
21505-500		DATE	2/2/2017
SCALE		DATE	2/2/2017
1:1		DATE	2/2/2017
SHEET 1 OF 1		DATE	2/2/2017

Restriction on use, duplication, or disclosure of proprietary information. This document contains proprietary information which is the sole property of Werlatone, Inc.
Werlatone, Inc. 17 Jon Barrett Road Patterson, NY 12563 T:(845)278-2220 F:(845)278-3440 sales@werlatone.com www.werlatone.com